

How to use a Breezhaler

1. Pull the dust cap upwards to reveal the mouthpiece.
2. Hold the base of the inhaler firmly and tilt the mouthpiece.
3. With dry hands, peel back the foil on the blister pack, remove one capsule and place in the capsule chamber. Close the mouthpiece firmly until you hear a click.
4. Hold the Breezhaler with mouthpiece pointing upwards and pierce the capsule by firmly pressing together both side buttons at the same time and release. You will hear a click.
5. Breathe out gently away from the device.
6. Hold mouthpiece at right angles to the mouth and place between the teeth, close lips around the mouthpiece.
7. Breathe in rapidly, steadily and deeply, you will hear the capsule whirr
8. Hold breath for 5-10 seconds and remove inhaler from the mouth. Breathe out slowly
9. If the capsule is not completely empty, repeat steps 5-8
10. Open the mouthpiece and tip out the used capsule and dispose in household waste. Close the cap.

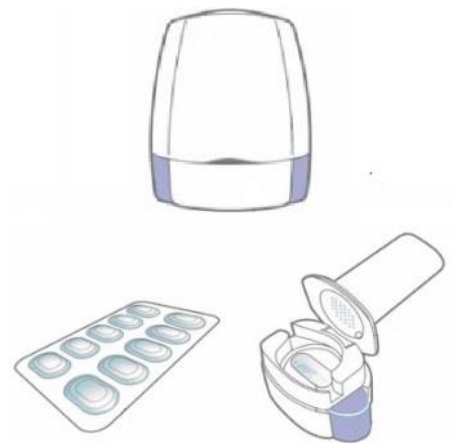

Demonstrate your device technique to your GP, nurse, pharmacist or clinical specialist at every opportunity